



REORDER NUMBER:

## RTG-01003

# RespVent™ HME 1500

## Heat Moisture Exchanger with Integrated Flex Tube

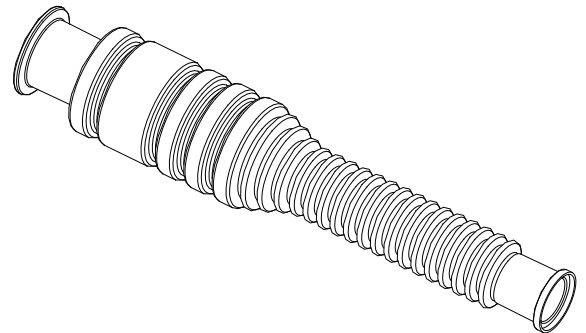

Clean, Ready to Use  
For Single Patient Use

### RxOnly

Caution: Federal law (USA)  
restricts this device to use by  
or at the direction of a physician

#### INSTRUCTIONS FOR USE:

Change the HME every 24 hours or sooner if necessary  
Not for use with nebulizers or vaporizing humidifiers.

#### INDICATIONS:

The *RespVent™ 1500 HME* is indicated to provide heat and moisture by capturing expired heat and moisture and returning it to the patient's lungs via inspired gases.

#### CONTRAINDICATION:

The *RespVent™ 1500 HME* is contraindicated in patients producing fulminating, frothy secretions within their airways and lungs.  
*RespVent™ 1500 HME* should not be used in conjunction with nebulizers or heated humidifiers.

#### SPECIFICATIONS:

Volume: 90 ml including integrated flex tube  
Resistance: 2.0 cm H<sub>2</sub>O at 60 L/min  
VP up to: 1500 ml

#### CAUTIONS:

Patient tubing and its connections to *RespVent™ 1500 HME* should be properly attached and checked for leakage prior to use.  
During the use of *RespVent™ 1500 HME* the patient should be closely monitored and proper airway care undertaken if complications arise.

#### WARNING:

*RespVent™ 1500 HME* is designed use only and should not be cleaned and reused.  
Compensation of ventilation may be necessary when using *RespVent™ 1500 HME* since it will add 90 ML of dead space to the system.

#### CONNECTION:

*RespVent™ 1500 HME* should be placed between the proximal end of the artificial airway and the Y-piece of the breathing circuit.

STORAGE TEMPERATURE:  
-30°C/-22°F  
+40°C/+104°F

For more info

Telephone  
323-761-0035

E-mail  
info@rtghealth.com

www.rtghealth.com