



REORDER NUMBER:

RTG-01051

RespVent™ Tracheostomy T-HME

With Suction Port

RxOnly

Caution: Federal law (USA) restricts this device to use by or at the direction of a physician

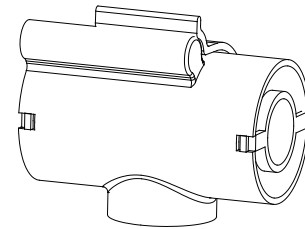

Clean, Ready to Use
For Single Patient Use

INSTRUCTIONS FOR USE:

Change the HME every 24 hours, or sooner if necessary
Not for use with nebulizer or vaporizing humidifiers

INTENDED USE:

RespVent™ Trach T-HME is a single use heat and moisture exchanger which transfers heat and humidity from the gas expired by the patient to the inspired gases. RespVent™ Trach T-HME is intended for use on patients who are breathing spontaneously through a tracheostomy tube.

CONTRAINDICATION:

RespVent™ Trach T-HME shall not be used on patients producing fulminating frothy secretions within their airway and lungs.
RespVent™ Trach T-HME shall not be used on patients with very small tidal volumes, for example neonates or very small children.

SPECIFICATIONS:

Minimum tidal volume: 50 ml
Breathing Resistance: 0.2 cm H₂O at 30 l/min
Deadspace: 15 ml
Connector-patient side: 15 F

CAUTIONS:

During the use of the RespVent™ Trach T-HME, the patient should be closely monitored and proper airway care undertaken if complications arise.
Before use, verify that the RespVent™ Trach T-HME has no occlusions and that air will flow through it.

WARNING:

RespVent™ Trach T-HME is designed for single patient use only and should not be cleaned and reused.

CONNECTION:

CONNECTORS ISO STD
Patient: 15mm F

STORAGE TEMPERATURE:
-30°C/-22°F
+40°C/+104°F

For more info

Telephone
| 323-761-0035

E-mail
| info@rtghealth.com

www.rtghealth.com